



Cobalt Geosciences, LLC
P.O. Box 82243
Kenmore, Washington 98028

October 25, 2021
Updated December 1, 2021

Mark Perkoski
Mark_perkoski@edwardrose.com

RE: Comment Letter
Oslo Bay Apartments
SR 305
Poulsbo, Washington

In accordance with your authorization, Cobalt Geosciences, LLC has prepared this letter to provide geotechnical responses to a comment letter by Aspect Consulting dated October 11, 2021.

We have reviewed the Geotechnical Engineering Report (EnviroSound Consulting, November 23, 2020) and the Limited Geotechnical Report (EnviroSound Consulting, June 21, 2017) and are in agreement with the provided information. Our March 2021 report supersedes previous recommendations from EnviroSound. We have also reviewed the provided civil drawings by KPFF and are in general agreement with the geotechnical related information contained therein or referenced. We have no comments with regard to the provided plans at this time.

We accept the role of geotechnical engineer of record for the project. We must be on site to verify relevant aspects of construction and in order to provide any location-specific modifications/recommendations that may be warranted during construction.

Aspects of construction that require periodic to full-time geotechnical oversight include:

- Erosion control placement (CESCL to be provided by others)
- Temporary excavations for mass grading
- Fill placement and compaction (anticipated to be provided by Krazan or another testing firm with our oversight)
- Proofrolls of roads
- Wall construction with geogrid placement where relevant
- Perforated collection drain placement (walls, footings, etc.)
- Benching of any areas to be filled
- Pond construction
- Slab-on-grades
- Soil bearing of all walls and foundations

Additional services could be required or requested depending on the soil conditions encountered during construction. We have included an updated Figure 1 that shows the Vetter Road area. Note that infiltration and detention are no longer proposed. The area will include a water-tight water quality vault.

Sincerely,

Cobalt Geosciences, LLC

Phil Haberman, PE, LG, LEG
Principal

From Previous Plans when Infiltration was Proposed

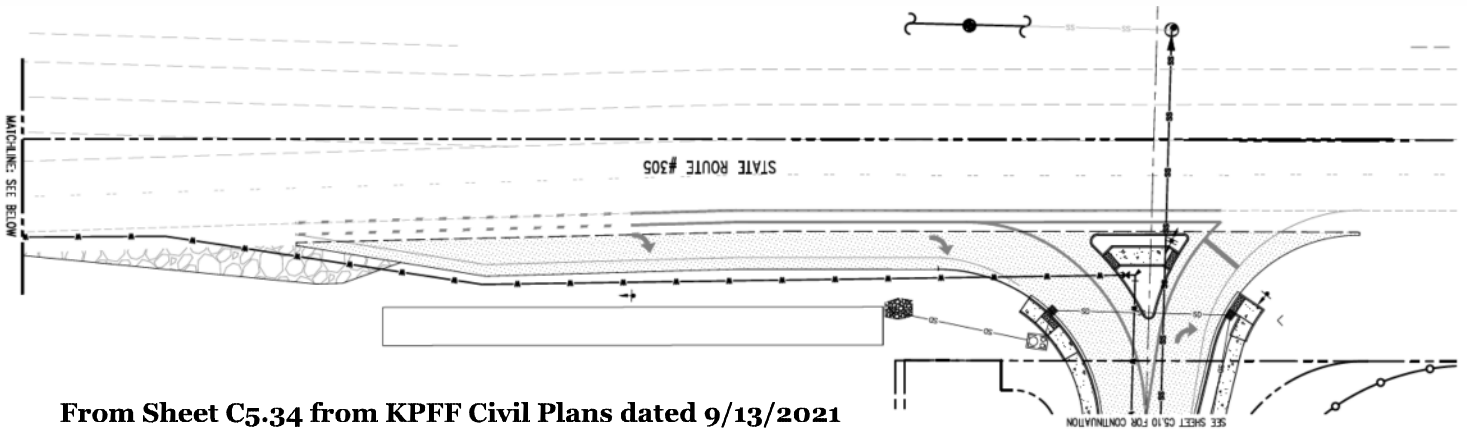
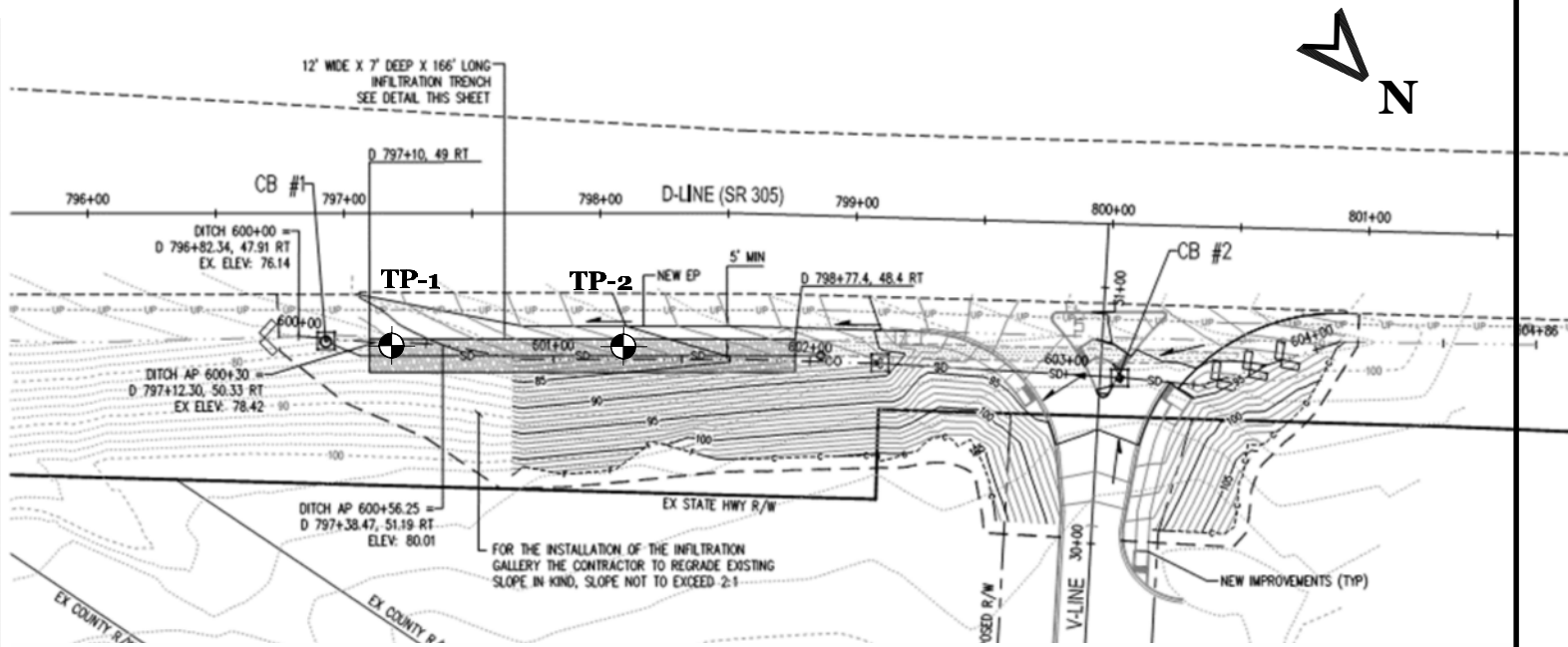

From Sheet C5.34 from KPFF Civil Plans dated 9/13/2021

TP-1 **Approximate Test Pit Location**

Not to Scale

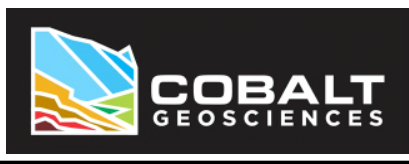

Geotechnical Evaluation
Oslo Bay Apartments
Poulsbo, Washington

SITE PLAN
FIGURE 1

Cobalt Geosciences, LLC
P.O. Box 82243
Kenmore, WA 98028
(206) 331-1097
www.cobaltgeo.com
cobaltgeo@gmail.com